

Yard Duty and Super Vison Policy Altona North Campus



Help for non-English speakers

If you need help to understand this policy, please contact the school on 9393 5800

Purpose |

To ensure school staff understand their supervision and yard duty responsibilities.

Scope |

The principal is responsible for ensuring that there is a well organised and responsive system of supervision in place during school hours, before and after school, and on school excursions and camps.

This policy applies to all teaching and non-teaching staff at Bayside P-12 College, including education support staff, casual relief teachers and visiting teachers.

School staff are responsible for following reasonable and lawful instructions from the principal, including instructions to provide supervision to students at specific dates, time and places.

Policy |

Before and after school |

Bayside P-12 College's grounds are supervised by school staff from 8.41am until 3.25pm. Outside of these hours, school staff will not be available to supervise students.

Before and after school, school staff will be available to supervise the school entrance and Primary play area.

Parents and carers should not allow their children to attend Bayside P-12 College outside of these hours. Families are encouraged to contact Robert Evans on 9392 8600 for more information about the before and after school care facilities available to our school community.

If a student is not collected before supervision finishes at the end of the day, the principal or nominee staff member will consider whether it is appropriate to:

- attempt to contact the parents/carers
- attempt to contact the emergency contacts
- contact Victoria Police and/or the Department of Health and Human Services (Child Protection) to arrange for the supervision, care and protection of the student.

School staff who are rostered on for before or after school supervision must follow the processes outlined below.

Yard duty |



Yard Duty and Super Vison Policy Altona North Campus

All staff at Bayside P-12 College are expected to assist with yard duty supervision and will be included in the weekly roster.

The principal is responsible for preparing and communicating the yard duty roster on a regular basis. At Bayside P-12 College, school staff will be designated a specific yard duty area to supervise.

The designated yard duty areas for our school

| Area | Description |
|--------|---|
| Area A | Canteen / Oval / Hive |
| Area B | Primary FWing (Y5-Y9), Primary Wing & General Office |

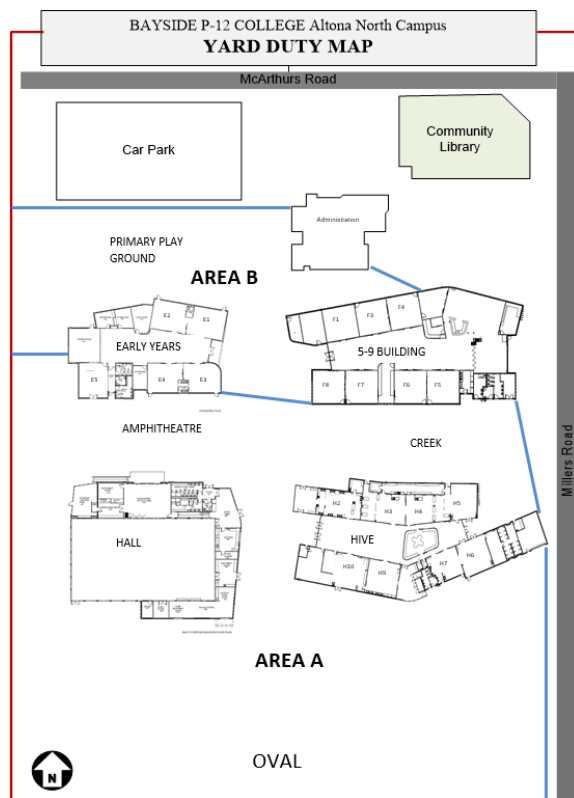

School staff must wear a provided safety/hi-vis vest whilst on yard duty. Safety/hi-vis vests will be stored in the General Office.

Staff who are rostered for yard duty must remain in the designated area until they are replaced by a relieving teacher.

During yard duty, supervising staff must:



Yard Duty and Super Vison Policy Altona North Campus

- methodically move around the designated zone be alert and vigilant
- intervene immediately if potentially dangerous or inappropriate behaviour is observed in the yard
- enforce behavioural standards and implement appropriate consequences for breaches of safety rules, in accordance with any relevant disciplinary measures set out in your school's Student Engagement and Wellbeing policy
- ensure that students who require first aid assistance receive it as soon as practicable
- log any incidents or near misses as appropriate with the General office
- if being relieved of their yard duty shift by another staff member (for example, where the shift is 'split' into 2 consecutive time periods), ensure that a brief but adequate verbal 'handover' is given to the next staff member in relation to any issues which may have arisen during the first shift.

If the supervising staff member is unable to conduct yard duty at the designated time, they should contact the Daily Organiser with as much notice as possible prior to the relevant yard duty shift to ensure that alternative arrangements are made.

If the supervising staff member needs to leave yard duty during the allocated time, they should contact the Daily Organiser but should not leave the designated area until the relieving staff member has arrived in the designated area.

If a relieving or next staff member does not arrive for yard duty, the staff member currently on duty should contact the campus office and not leave the designated area until a replacement staff member has arrived.

Should students require assistance during recess or lunchtime, they are encouraged to speak to the supervising yard duty staff member.

Classroom |

The classroom teacher is responsible for the supervision of all students in their care during class.

If a teacher needs to leave the classroom unattended at any time during a lesson, they should first contact General office for assistance. The teacher should then wait until another staff member has arrived at the classroom to supervise the class prior to leaving.

School activities, camps and excursions |

The principal and leadership team are responsible for ensuring that students are appropriately supervised during all school activities, camps and excursions, including when external providers are engaged to conduct part or all of the activities. Appropriate supervision will be planned for special school activities, camps and excursions on an individual basis, depending on the activities to be undertaken and the level of potential risk involved.

Further Information and Resources |

- School Policy and Advisory Guide:
 - [Supervision](#)
 - [Duty of Care](#)
 - [Child Safe Standards](#)
 - [Visitors in Schools](#)

Approval |



Yard Duty and Super Vison Policy Altona North Campus

Consultation | College Council & Student Representative Group

Date of approval by College Council | 10th August

Review Date | August 2024



Bayside P-12 College